

September 2012

## Trimmer - Spotlight w/dimmable electronic transformer 50W 12 V QR CBC 51

**Product code:**  
2720

**Technical description:**

Luminaire for 1x50W QR CBC 51 low voltage halogen lamp. Made up of dimmable electronic transformer, adapter for mains voltage electrified tracks, support arm and optical assembly. The support arm is made up of two diecast aluminium elements joined with M2.5 screws and houses the power supply cable for the lamp. The diecast aluminium optical assembly is joined to the lower end of the arm with M3 screws on conic steel washers. It can be inclined by 100° with screw locking device and rotated by 340° about the vertical axis with continuous friction and screw locking device.

**Installation:**

On iGuzzini mains voltage electrified tracks.

**Dimension:**

73x152mm

**Colour:**

White (01)|Black (04)|Grey (15)

**Mounting:**

Three circuit track

**Wiring:**

Dimmable electronic transformer.

**Notes:**

For the photometric data of the luminaire refer to the photometric characteristics of the light sources used.

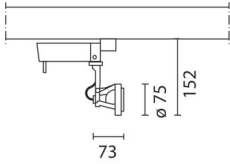

Complies with EN605981 and pertinent regulations

