

September 2012

Gabbiano - Floodlight with electronic control gear 150 W HIT Flood**Attention! Code out of production - 2012****Product code:**

2717

Technical description:

Indoor spotlight made up of fibre glass reinforced thermoplastic cradle, optical assembly inside the cradle, lamp-support ring, diecast lampholder cover plate and mechanical locking system for optical assembly setting situated at one end of the cradle. Control gear box made up of a diecast aluminium bearing base with the electrical components for discharge lamps, moulded polycarbonate cover with 850° NF C20 paint finish, aluminium mechanical fixing system with screw and helicoidal spring for correct positioning. IP40 for optical assembly with optional glass diffusers.

Installation:

On iGuzzini mains voltage electrified tracks. Compatible with Erco, Nokia, Staff and Hoffmaister tracks.

Dimension:

349x351mm

Colour:

White (01)|Grey (15)

Mounting:

Three circuit track

Wiring:

Electrical components for discharge lamps contained inside the box integrated to the luminaire.

Notes:

Complete with protection glass and capacitor.

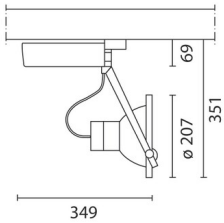

Complies with EN605981 and pertinent regulations

