

September 2012

**Gabbiano - Spotlight with electronic control gear 35 W HIT (CDM-TC) Flood****Product code:**

2708

**Technical description:**

Spotlight for interior lighting made up of a cradle in thermoplastic material reinforced with high-solidity fiber glass, an optical assembly inside the cradle, a die-cast aluminium lampholder cover plate and lamp-support ring, a mechanical locking device to guarantee stability of the optical assembly at one end of the cradle. The technopolimer transformer compartment is joined to the adapter. IP40 for optical assembly with optional glass diffusers.

**Installation:**

On iGuzzini mains voltage electrified tracks. Compatible with Erco, Nokia, Staff and Hoffmaister tracks.

**Dimension:**

309x243mm

**Colour:**

White (01)|Grey (15)

**Mounting:**

Three circuit track

**Wiring:**

Electrical components for discharge lamps contained inside the box integrated to the luminaire.

**Notes:**

Complete with protection glass and capacitor.

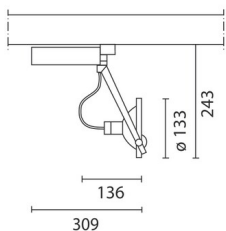

Complies with EN605981 and pertinent regulations

