

# TUBE CARRÉ

13-Dec.-2016

## 3.0

2xPAR16 max.35W | GU10 | 100-240VAC | 50-60Hz

CE IP65 0.9m

white texture  
dark grey texture  
black texture

712320W0  
712320D0  
712320B0

OPTIONAL  
for PAR16 lamps see our catalogue

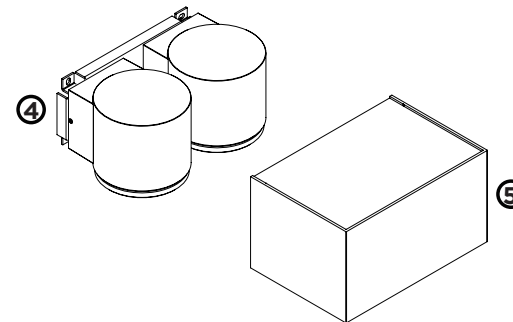
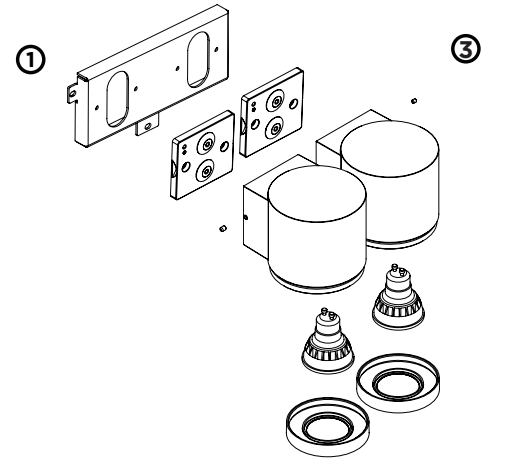
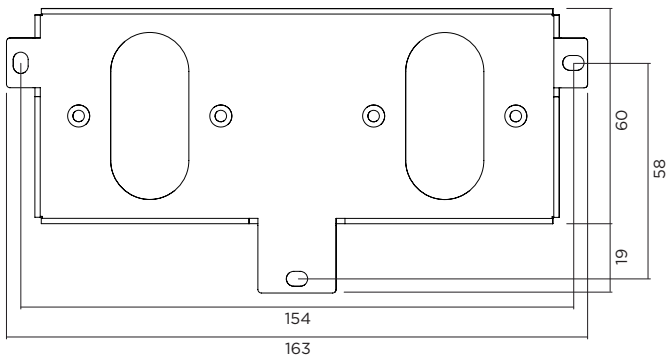

Slide the cover straight onto the device (not skewed) to prevent the springs from deforming

## DIMENSIONS

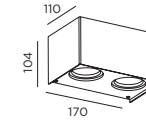

### 1 MOUNTING INSTRUCTION

Remove the backplate and fixate it to the wall with screws.

### 2 POWER CONNECTION

Exterior: WATERPROOF Connection

IP-rated connections for wall fixtures: cable isolation for round cables  $\varnothing$  4.5-7.5 mm, should be in the grommet. For cable use  $\varnothing$  7.0-9.5 mm: replace the grommet with the other grommet in the bag.

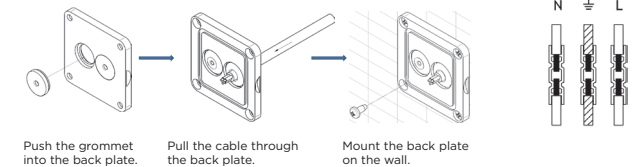

### 3 Fixate the fixture base to the back plate.

4 Remove the glass cover by turning it. Insert the lamp. Turn the glass cover back on the fixture.

5 Click the TUBE CARRÉ cover over the fixture



WEVER & DUCRÉ  
LIGHTING

[www.weverducre.com](http://www.weverducre.com)

Wever & Ducre bvba Kwadestraat 153 bus 2.1 8800 Roeselare

INSTALLATION  
INSTRUCTIONS