

# TUBE CARRÉ

13-Dec.-2016

## 2.0 LED

**LED** 2xLED 8W | 220-240VAC | 50-60Hz | COB 2-step | incl. PS | phase-cut dim

CE  $\oplus$  IP65  $\text{D}_{0.3m}$   $\text{G}$   $\text{D}$   $\text{X}$

3000K | >80CRI | 2x480lm

white texture  
dark grey texture  
black texture

712264W4

712264D4

712264B4

## 2.0 PAR16

**PAR16** 2xPAR16 max.35W | GU10 | 100-240VAC | 50-60Hz

CE  $\oplus$  IP65  $\text{D}_{0.9m}$   $\text{G}$   $\text{D}$   $\text{X}$

white texture  
dark grey texture  
black texture

712220W0

712220D0

712220B0

### OPTIONAL

for PAR16 lamps see our catalogue

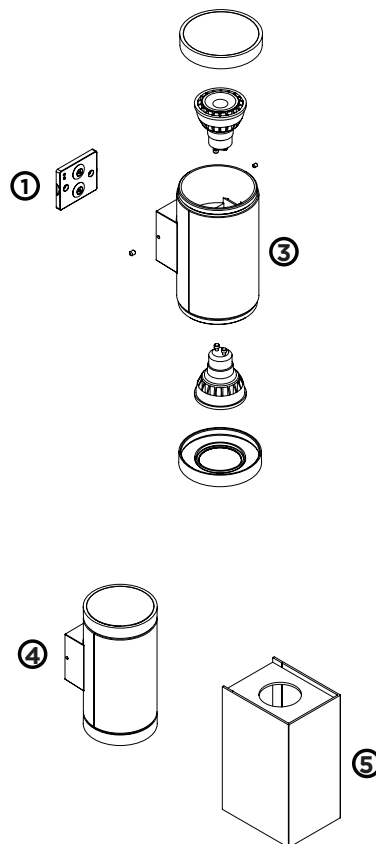
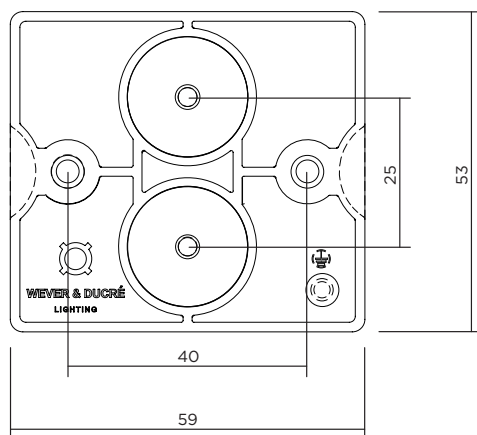

Slide the cover straight onto the device (not skewed) to prevent the springs from deforming

## DIMENSIONS

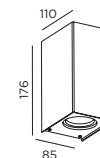

### 1 MOUNTING INSTRUCTION

Remove the backplate and fixate it to the wall with screws.

### 2 POWER CONNECTION

Exterior: WATERPROOF Connection

IP-rated connections for wall fixtures: cable isolation for round cables  $\varnothing$  4.5-7.5 mm, should be in the grommet. For cable use  $\varnothing$  7.0-9.5 mm: replace the grommet with the other grommet in the bag.

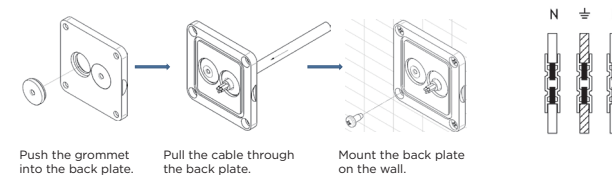

### 3 Fixate the fixture base to the back plate.

### 4 Remove the glass cover by turning it. Insert the lamp. Turn the glass cover back on the fixture.

### 5 Click the TUBE CARRÉ cover over the fixture