

TORCO ON TRACK

17-Mar.-2017

1.0 LED

LED 15W | 220-240VAC | 50-60Hz | COB 3-step | incl. 3-phase track adapter | phase-cut dim

CE IP20 0.3m 40° 90° 355°

white texture
black texture

158168W_
158168B_

LIGHT COLOUR

2700K | >80CRI | 950lm
3000K | >80CRI | 1050lm

2
4

OPTIONAL

dimmer
for switch
for din rail

90019017
90019018

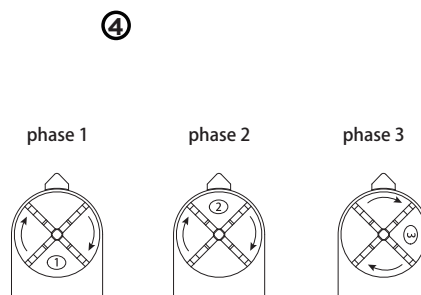
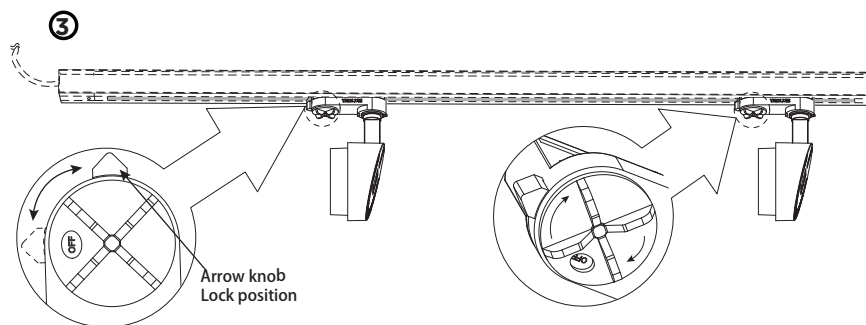
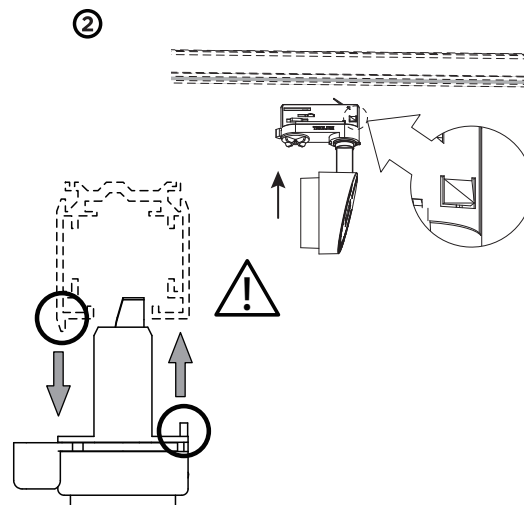
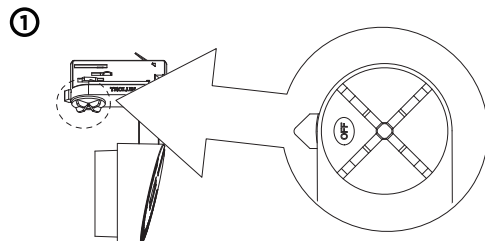

DIMENSIONS

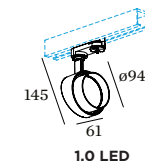

1.0 LED

MOUNTING INSTRUCTION

- ① Make sure the knob is on the OFF position.
- ② Push the fixture into the track.
- ③ Turn the knob to the Lock position.
- ④ Select the phase.

The light source of the integrated LED is not replaceable;
When the light source reaches its end of life the whole
luminaire shall be replaced.



Caution, risk of electric shock