



REVER DINING

17-Oct.-2017

1.0

LED 2.5W | touch dim | magnetic pole with additional base | rechargeable li-ion battery incl. usb charging | lights for 8 hours | powder coated zink alloy | PMMA | cable 1.5 m

CE IP23 (10.3m)  

2700K | 160lm

 white texture	655184W2
 black texture	655184B2

OPTIONAL magnetic flat plate

 white texture	90019163
 black texture	90019164

Single charging Tray with magnetic fix

 white texture	90019165
 black texture	90019166

Multiple charger 4 pieces

 black texture	90018007
-------------------------------------------------------------------------------------------------	----------

Refill Battery

Rechargeable Lithium Battery	73240633
------------------------------	----------

DIMENSIONS

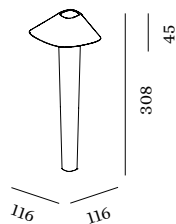

REVER DINING

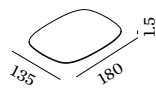

MAGNETIC FLAT PLATE

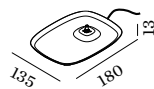

SINGLE CHARGING TRAY WITH MAGNETIC FIX

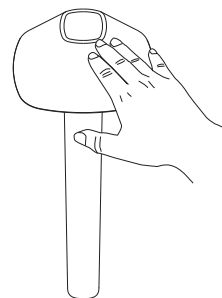
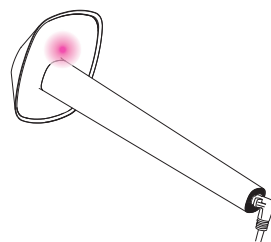
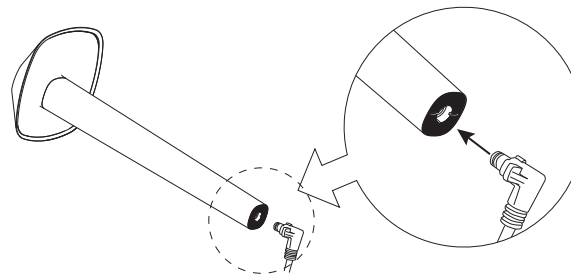

the Power

- The luminaire is powered by a built-in lithium battery, 3.7V/4000mA.
- The luminaire is charged with a 5V DC/500mA constant voltage power supply.
- It takes about 10 hours for the luminaire to be fully charged.
- The luminaire can work continuously for 8 hours after a fully charging.
- During the charging process, the luminaire can be used normally

the Indicator Lights

- When it is in charge, the red LED indicator is ON.
- When the charge is full, the red LED indicator goes OFF
- When the voltage of the battery is too low (lower then 3.3V) , the yellow LED indicator is ON.
- When the battery voltage is below 3.0V, the luminaire goes into sleep mode.
- When the luminaire is in sleep mode, the lamp is not going to be lighted when touching the touch switch. But there will be a yellow LED Indicator Flashing 5 times

Switch on/off and Dimming

- The touch switch & touch dimmer is the lamp cover's metal top. The user can control the luminaire on/off and dimming by touching it.
- Touch for 3 seconds to turn on the light. (The brightness of the light will be as same as the previous time.)
- After turning on the light, touch for 3 seconds to turn off the light.
- After turning on the light, touch for less than 1 second to shift gears of brightness. The shift sequence according to low - middle - high cycle.

REVER DINING

Optional accessories

17-Oct.-2017

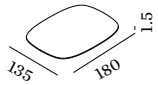

MAGNETIC
FLAT PLATE

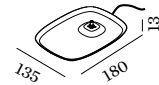
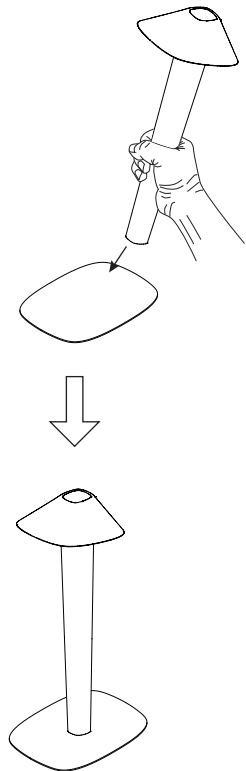

SINGLE CHARGING TRAY
WITH MAGNETIC FIX

including:

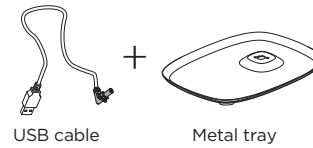

USB cable

Metal tray

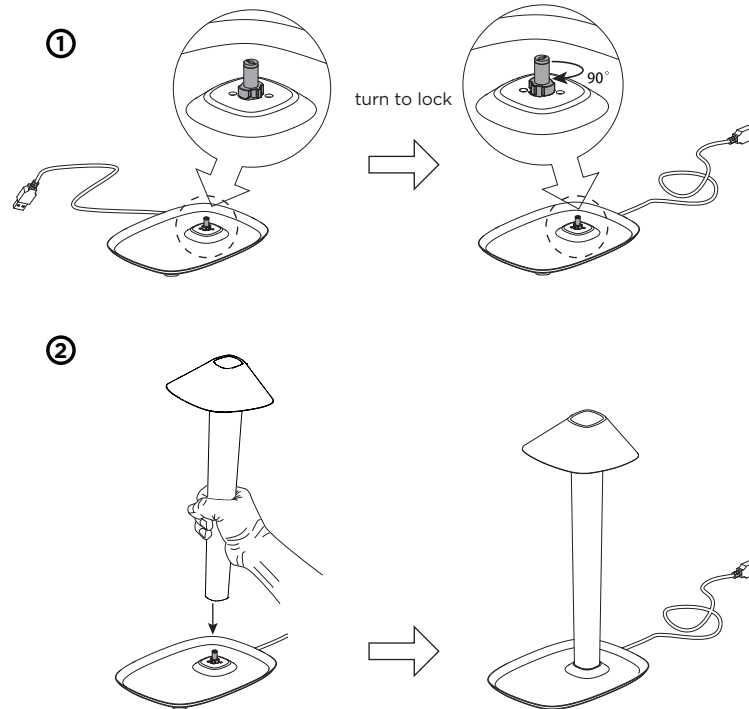

WEVER & DUCRÉ
LIGHTING

www.weverducre.com

Wever & Ducre bvba Kwadestraat 153 bus 2.1 8800 Roeselare

INSTALLATION
INSTRUCTIONS

PAGE 2/2