

GO-ON

08-06-2015

1.0 LED111

LED 13W | 220-240V | 50-60Hz | AC-COB 3-step | phase-cut dim

CE IP20 960° C 0,3m A38° P 45°/45° 45°/45°

white texture
silver / grey

116168W_
116168S_

LIGHT COLOUR

2700K | >80CRI | 640lm
3000K | >80CRI | 680lm

2
4

base plate dimensions

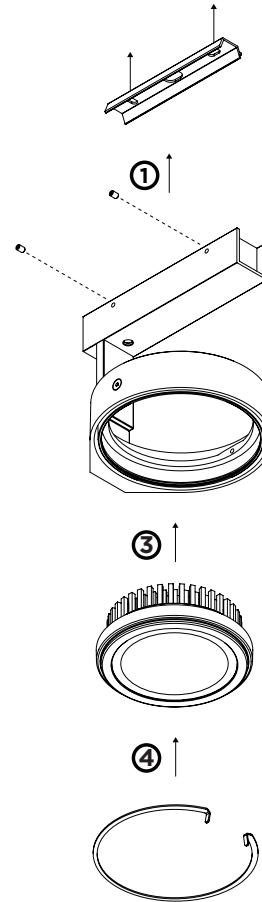
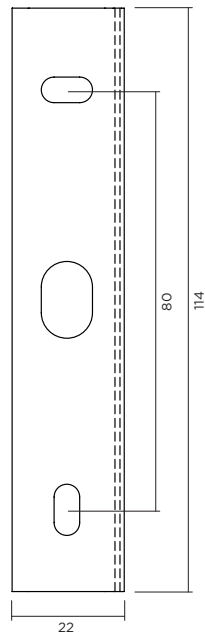

DIMENSIONS

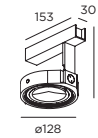

MOUNTING INSTRUCTION

- 1 Attach the base plate to the ceiling with screws

POWER CONNECTION

- 2 PARALLEL CONNECTION
driver is included

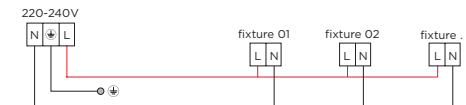

- 3 Attach the fixture to the base plate with the side screws
- 4 Insert the lamp and fix with spring



WEVER & DUCRÉ
LIGHTING

www.weverducre.com

INSTALLATION
INSTRUCTIONS