

TECHNICAL DATA SHEET ART. S.6539 - BUL 24

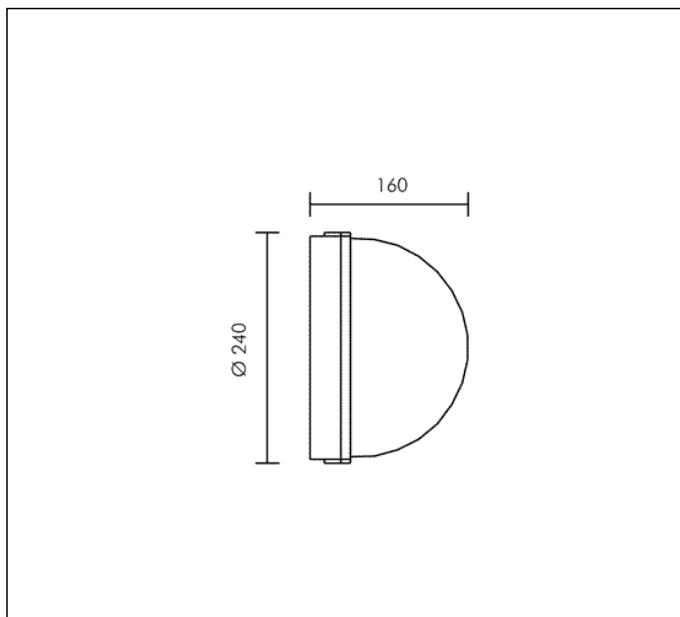

TC-DEL 18W G24q-2 1200lm
 Rated luminaire luminous flux: 624lm
 Rated input power: 22W
 Luminaire efficacy: 28lm/W (LOR: 52%)
 Electronic ballast 230÷240V 50Hz

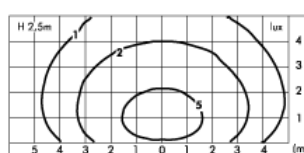
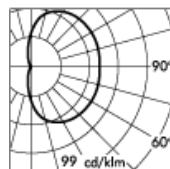

CE IP 54

PRODUCT TYPE

Wall mounted luminaire. IP rating IP 54

MATERIAL CHARACTERISTICS

Aluminium die cast housing in EN AB-47100 (low copper content) with high resistance against corrosion. Stone wash surface treatment prior to painting process. A4 grade Stainless Steel screws with 2,5-3% molybdenum content which increases the resistance against corrosion. EPDM gaskets. Painting Process : 3 Step Process

1) Surface treatment with BONDERITE. A heavy metal free chemical surface treatment containing ceramic nano particles giving a cohesive, inorganic and highly dense protective coating. 2) PRE POLYMERIZATION a process of introducing an epoxy primer with excellent characteristics to the paint which also offers very high resistance to oxidation due to its Zinc content. 3) POLYMERIZATION a process with the application of polyester powder with high resistance against UV rays and harsh weather conditions. Resistance test protection for Marine applications for 1200h. Mechanical resistance --

LIGHTING PERFORMANCE

Sand blasted glass diffuser. Lamp fixed position. LOR 52%

WIRING

Supply double cable entry. Isolation: CLASS I . Available colours: White (cod.01), Black (cod.09), Aluminium grey (cod.14). Weight: 2.2 Kg Glow Wire test: 960°C
Lamp not included.

This luminaire is compatible with bulbs of the energy classes: A (Regulation UE 874/2012).

EMERGENCY VERSIONS

On request the fittings could be provided with electronic ballast which operate both on AC (50/60Hz), both on DC (0Hz) voltage.