

LIGHT SHADOW FIXED TRIM 2 SPOTS OPTIC MEDIUM

Mounting	Ceiling recessed
Lamps description	Power LED 5,4W 560 lm 3000K CRI 90
Luminaire luminous flux	Extreme Cut-off. See reference number
Environment	Indoor
Notes	Pre-installation frame not required.

OPTICAL

Aiming	Fixed
Light distribution symmetry	Symmetric
Beam angle	23° Medium

ELECTRICAL

Transformer availability	Included
Transformer mounting	Remote
Transformer type	Electronic
Emergency	Without
Insulation class	Class II

PHYSICAL

Length (mm)	77
Recessed depth (mm)	75
Weight (kg)	0,25



Light Shadow Fixed Trim 2 Spots Optic Medium

designed by FLOS Architectural

Recessed integrated luminaire with 2 LED lighting spots. Remote power supply included.

	03.9110.40 - 421lm	White / White
	03.9110.14 - 421lm	Black / White
	03.9112.40 - 427lm	White / Chrome
	03.9112.14 - 427lm	Black / Chrome
	03.9113.40 - 419lm	White / Matt Gold
	03.9113.14 - 419lm	Black / Matt Gold
	03.9111.40 - 414lm	White / Black
	03.9111.14 - 414lm	Black / Black

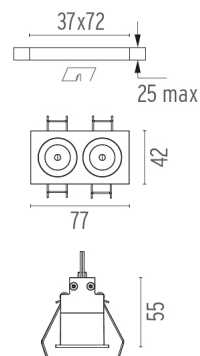
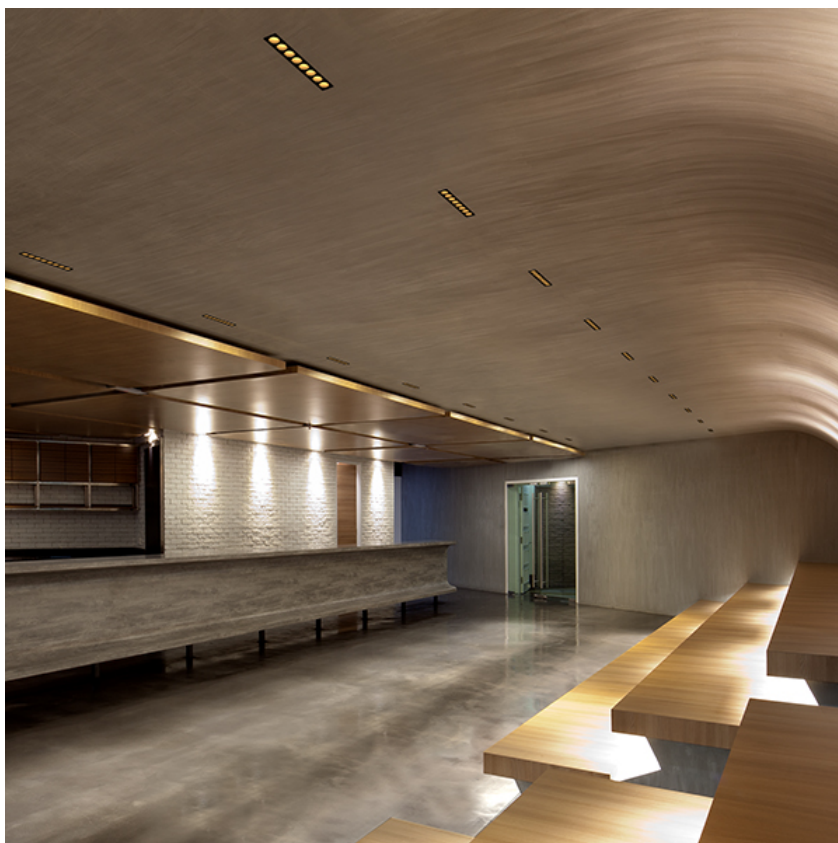

CERTIFICATIONS

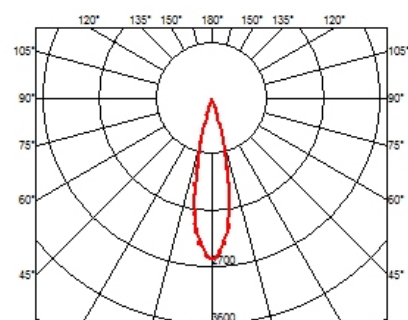
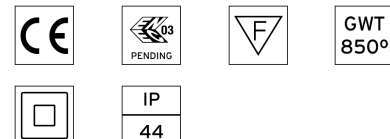

Light Shadow Fixed Trim 2 Spots Optic Medium . Lamps



Power LED

Lamp category:
LED

Socket:
Special base

Lamp type:
Power LED

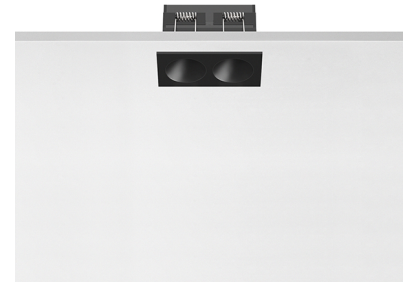

Light Shadow Fixed Trim 2 Spots Optic Medium

designed by FLOS Architectural

Recessed integrated luminaire with 2 LED lighting spots. Remote power supply included.

	03.9110.40 - 421lm	White / White
	03.9110.14 - 421lm	Black / White
	03.9112.40 - 427lm	White / Chrome
	03.9112.14 - 427lm	Black / Chrome
	03.9113.40 - 419lm	White / Matt Gold
	03.9113.14 - 419lm	Black / Matt Gold
	03.9111.40 - 414lm	White / Black
	03.9111.14 - 414lm	Black / Black

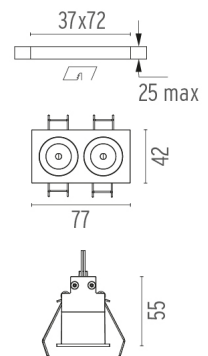

CERTIFICATIONS

