

## LIGHT SHADOW FIXED TRIM DALI VERSION 2 SPOTS OPTIC MEDIUM

<b>Mounting</b>	Ceiling recessed
<b>Lamps description</b>	Power LED 5,4W 560 lm 3000K CRI 90
<b>Luminaire luminous flux</b>	Extreme Cut-off. See reference number
<b>Environment</b>	Indoor
<b>Notes</b>	Pre-installation frame not required.

### OPTICAL

<b>Aiming</b>	Fixed
<b>Light distribution symmetry</b>	Symmetric
<b>Beam angle</b>	23° Medium

### ELECTRICAL

<b>Transformer availability</b>	Included
<b>Transformer mounting</b>	Remote
<b>Transformer type</b>	Electronic dimmable dali
<b>Emergency</b>	Without
<b>Insulation class</b>	Class II

### PHYSICAL

<b>Length (mm)</b>	77
<b>Recessed depth (mm)</b>	75
<b>Weight (kg)</b>	0,25



**Light Shadow Fixed Trim Dali Version 2 Spots Optic Medium**

designed by FLOS Architectural

Recessed integrated luminaire with 2 LED lighting spots. Remote power supply included.

- 03.9110.40.DA - 421lm White / White
- 03.9110.14.DA - 421lm Black / White
- ◐ 03.9112.40.DA - 427lm White / Chrome
- ◑ 03.9112.14.DA - 427lm Black / Chrome
- ◒ 03.9113.40.DA - 419lm White / Matt Gold
- ◓ 03.9113.14.DA - 419lm Black / Matt Gold
- ◔ 03.9111.40.DA - 414lm White / Black
- ◕ 03.9111.14.DA - 414lm Black / Black

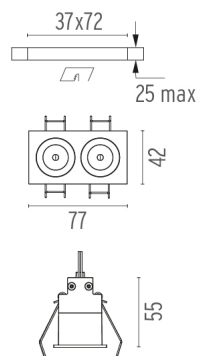
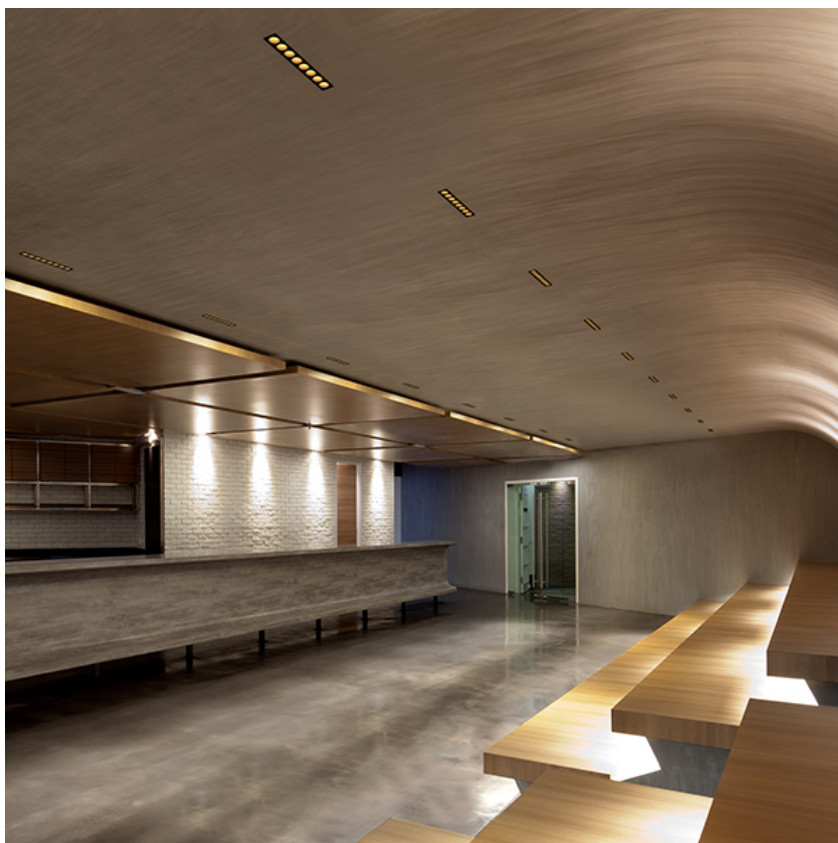

### CERTIFICATIONS

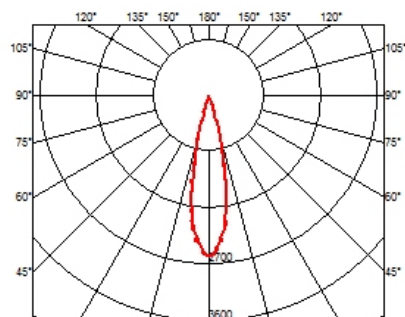
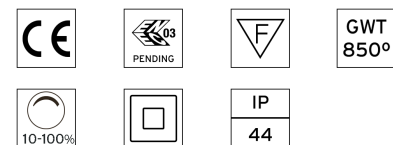

## Light Shadow Fixed Trim Dali Version 2 Spots Optic Medium . Lamps



**Power LED**

**Lamp category:**  
LED



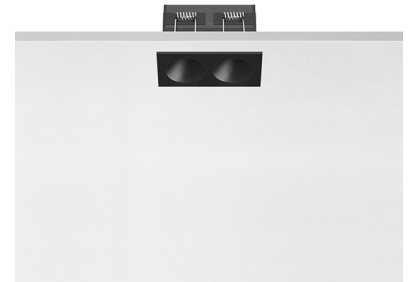

**Socket:**  
Special base

**Lamp type:**  
Power LED



**Light Shadow Fixed Trim Dali  
Version 2 Spots Optic Medium**  
designed by FLOS Architectural

Recessed integrated luminaire with 2  
LED lighting spots. Remote power  
supply included.

-  03.9110.40.DA - 421lm White / White
-  03.9110.14.DA - 421lm Black / White
-  03.9112.40.DA - 427lm White / Chrome
-  03.9112.14.DA - 427lm Black / Chrome
-  03.9113.40.DA - 419lm White / Matt Gold
-  03.9113.14.DA - 419lm Black / Matt Gold
-  03.9111.40.DA - 414lm White / Black
-  03.9111.14.DA - 414lm Black / Black

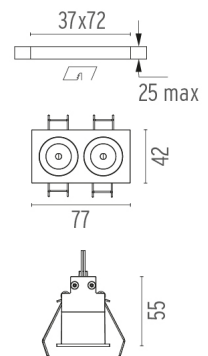

### CERTIFICATIONS

