

**BEGA****84 174**

Surface-mounted floodlight

IP 67

Project · Reference number

Date

**Product data sheet****Application**

LED On-ground floodlight for the illumination of vertical surfaces.

**Product description**

Luminaire made of aluminium alloy,  
aluminium and stainless steel  
BEGA Unidure® coating technology  
Matt safety glass  
Mounting plate made of stainless steel  
Steel grade number 1.4301  
4 elongated fixing holes  
Width 9 mm · 170 x 170 mm spacing  
for bolting onto a foundation  
3 elongated fixing holes  
Width 9 mm · pitch circle  $\varnothing$  132 mm  
Reflector made of pure anodised aluminium  
1,8 m water-resistant connecting cable  
07RN8-F 5G1<sup>□</sup> with implemented water  
stopper and 1.2 m PVC cable conduit  
LED power supply unit  
220-240 V  $\approx$  0/50-60 Hz  
DC 170-280 V  
DALI controllable  
A basic isolation exists between power cable  
and control line  
BEGA Thermal Control®  
Temporary thermal regulation to protect  
temperature-sensitive components without  
switching off the luminaire  
Safety class I  
Protection class IP 67  
Dust-tight and protection against temporary  
immersion  
Impact strength IK07  
Protection against mechanical  
impacts < 2 joule  
**CE** – Conformity mark  
Weight: 5.2 kg

**Lamp**

Module connected wattage	29.1 W
Luminaire connected wattage	33.2 W
Rated temperature	$t_a = 25^\circ\text{C}$
Ambient temperature	$t_{a\text{max}} = 35^\circ\text{C}$

On request we can offer you modifications for environments with higher temperatures as a customized product.

**84 174 K4**

Module designation	LED-0903/840
Colour temperature	4000 K
Colour rendering index	CRI > 80
Module luminous flux	5800 lm
Luminaire luminous flux	4201 lm
Luminaire luminous efficiency	126,5 lm/W

**84 174 K3**

Module designation	LED-0903/830
Colour temperature	3000 K
Colour rendering index	CRI > 80
Module luminous flux	5640 lm
Luminaire luminous flux	4085 lm
Luminaire luminous efficiency	123 lm/W

**Service life · Ambient temperature**

Rated temperature $t_a = 25^\circ\text{C}$	
LED psu:	> 50,000 h
LED module:	> 200,000 h (L.80 B50) 100,000 h (L.90 B50)

Ambient temperature $t_{a\text{max}} = 35^\circ\text{C}$ (100 %)	
LED psu:	50,000 h
LED module:	162,000 h (L.80 B50)

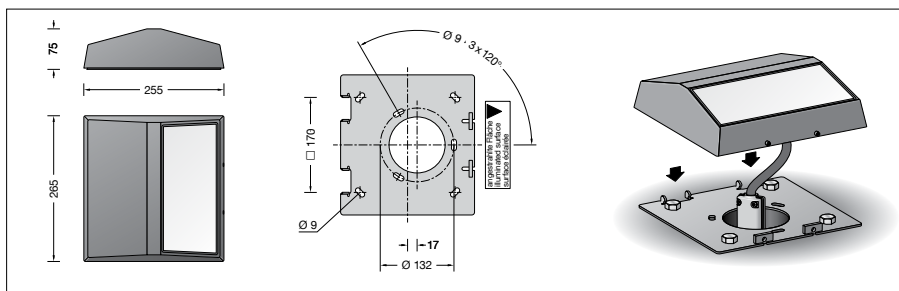
**Accessories**

**70 896** Anchorage unit with mounting flange made of hot-dip galvanised steel. Overall length 500 mm. 3 stainless steel M8 mounting screws. Pitch circle  $\varnothing$  132 mm.

**70 753** Connection housing made of stainless steel for installation in ground surfaces

Distribution box for installation in soil  
**70 730** Distribution box with 7 cable entries  
Connection terminals 5 x 4<sup>□</sup>

**71 053** Distribution box with 10 cable entries  
Connection terminals 6 x 16<sup>□</sup>

For the accessories a separate instructions for use can be provided upon request.

**Inrush current**

Inrush current: 5 A / 50  $\mu\text{s}$   
Maximum number of luminaires of this type per miniature circuit breaker:  
B 10A: 31 luminaires  
B 16A: 50 luminaires  
C 10A: 52 luminaires  
C 16A: 85 luminaires

**Light technique**

Luminaire data for the light planning program DIALux for outdoor lighting, street lighting and indoor lighting as well as luminaire data in EULUMDAT- and IES-format you will find on the BEGA web page [www.bega.com](http://www.bega.com).

**Article No. 84 174**

LED colour temperature optionally 4000 K or 3000 K  
4000 K – Article number + **K4**  
3000 K – Article number + **K3**