

**BEGA****84 038**

Pole top luminaire



Project · Reference number

Date

## Product data sheet

### Application

LED pole top luminaire with symmetrical light distribution.  
For lighting paths and parks in private or public sectors.  
A luminaire distinguished by its high corrosion resistance.  
For mounting heights 2000 - 2400 mm.

### Product description

Luminaire made of copper, brass and stainless steel  
Opal glass with screw neck  
Silicone gasket  
Mounting bush G 1/2 · ISO 228  
Connecting cable H05VV-F 3G1<sup>□</sup>  
Cable length 3 m  
LED power supply unit  
220-240 V ~ 0/50-60 Hz  
DC 198-280 V  
Safety class I  
Protection class IP 65  
Dust-tight and protection against water jets  
Impact strength IK06  
Protection against mechanical impacts < 1 joule  
 – Safety mark  
**CE** – Conformity mark  
Weight: 4.8 kg

### Inrush current

Inrush current: 5 A / 50 μs  
Maximum number of luminaires of this type per miniature circuit breaker:  
B 10A: 30 luminaires  
B 16A: 50 luminaires  
C 10A: 52 luminaires  
C 16A: 80 luminaires

### Lamp

Module connected wattage 13.4 W  
Luminaire connected wattage 15.8 W  
Rated temperature  $t_a = 25\text{ °C}$   
Ambient temperature  $t_{a\text{ max}} = 50\text{ °C}$

### 84 038 K3

Module designation LED-0904/830  
Colour temperature 3000 K  
Colour rendering index CRI > 80  
Module luminous flux 2625 lm  
Luminaire luminous flux 1743 lm  
Luminaire luminous efficiency 110,3 lm/W

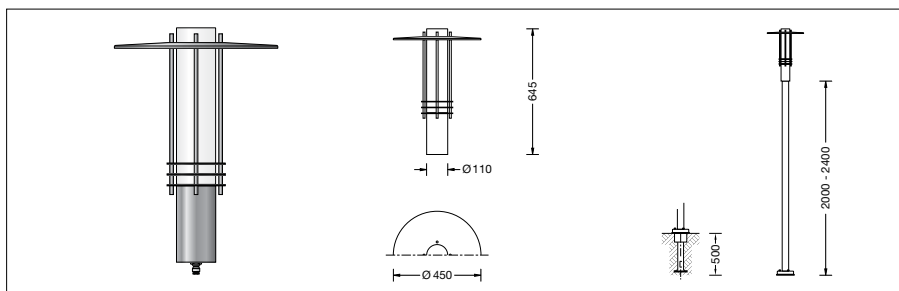
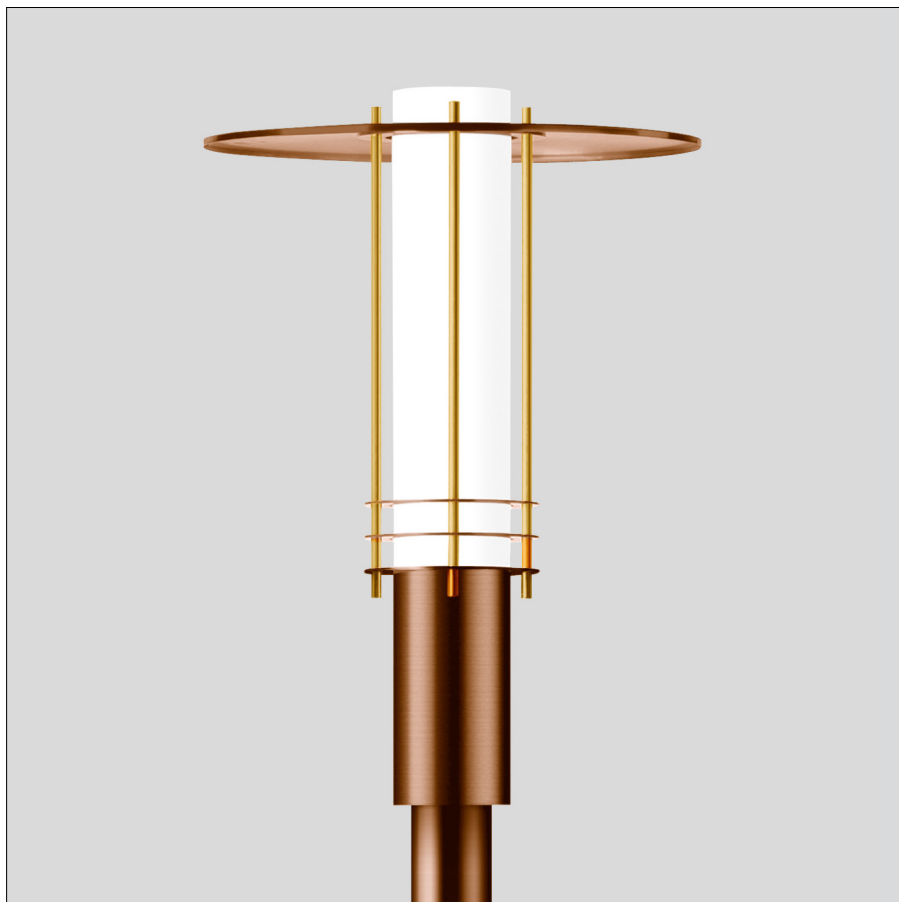

### Service life of the LED

Ambient temperature  $t_a = 25\text{ °C}$   
– at > 500,000h: L 70B50

max. ambient temperature  $t_a = 50\text{ °C}$   
– at 137,000h: L 70B50

### Light technique

Luminaire data for the light planning program DIALux for outdoor lighting, street lighting and indoor lighting as well as luminaire data in EULUMDAT- and IES-format you will find on the BEGA web page [www.bega.com](http://www.bega.com).

### Accessories

For this luminaire we recommend the following BEGA luminaire poles:

Cylindrical poles made of raw copper and baseplate made of cast bronze, without access door

**70 550** Pole with baseplate H 2000 mm  
**70 553** Pole with baseplate H 2000 mm  
**70 551** Pole with baseplate H 2400 mm

For the accessories a separate instructions for use can be provided upon request.

### Light distribution

