

BEGA**77 665**

Floodlight



Project · Reference number

Date

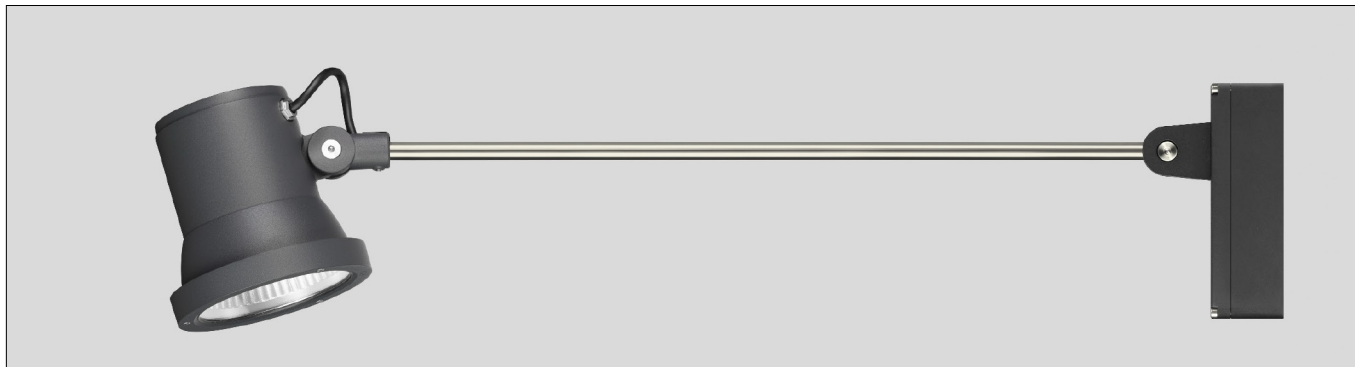

Product data sheet

Application

Floodlight with mounting box and outrigger arm for installation on ceilings and walls in interior and exterior application.

The adjustability of the outrigger arm allows a variety of burning positions with which most diverse lighting tasks can be solved.

For a variety of interior and exterior lighting applications.

Product description

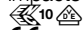
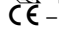
Luminaire made of aluminium alloy, aluminium and stainless steel
 BEGA Unidure® coating technology
 Clear safety glass
 Silicone gasket
 Reflector made of pure anodised aluminium
 Adjustment range:
 Joint - mounting box: $\pm 75^\circ$ in steps of 15°
 Swivel joint - outrigger arm: $\pm 165^\circ$
 Floodlight housing: $+95^\circ / -65^\circ$ infinitely adjustable
 Mounting box with 2 fixing holes
 $\varnothing 6.3$ mm · 48 x 160 mm spacing
 2 cable entries for through-wiring of mains supply cable $\varnothing 7$ -10.5 mm
 Connection terminal 2.5²
 Earth conductor connection
 LED power supply unit
 220-240 V \sim 0/50-60 Hz
 DC 176-264 V
 DALI controllable
 A basic isolation exists between power cable and control line
 BEGA Thermal Control®
 Temporary thermal regulation to protect temperature-sensitive components without switching off the luminaire
 Safety class I
 Protection class IP 65
 Dust-tight and protection against water jets
 Impact strength IK06
 Protection against mechanical impacts < 1 joule
 – Safety mark
 – Conformity mark
 Wind catching area: 0.042 m²
 Weight: 3.4 kg

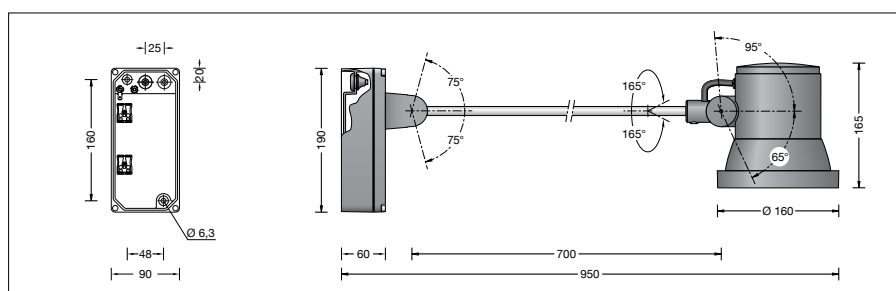

Lamp

Module connected wattage	17.5 W
Luminaire connected wattage	19.7 W
Rated temperature	$t_a = 25^\circ\text{C}$
Ambient temperature	$t_{a\text{max}} = 60^\circ\text{C}$

77 665 K4

Module designation	LED-0327/940
Colour temperature	4000 K
Colour rendering index	CRI > 90
Module luminous flux	2980 lm
Luminaire luminous flux	2127 lm
Luminaire luminous efficiency	108 lm/W

77 665 K3

Module designation	LED-0327/930
Colour temperature	3000 K
Colour rendering index	CRI > 90
Module luminous flux	2950 lm
Luminaire luminous flux	2063 lm
Luminaire luminous efficiency	104,7 lm/W

Service life · Ambient temperature

Rated temperature $t_a = 25^\circ\text{C}$	
LED psu:	> 50,000h
LED module:	> 200,000h (L80B50)
	100,000h (L90B50)

Ambient temperature $t_{a\text{max}} = 60^\circ\text{C}$ (100 %)

LED psu:	50,000h
LED module:	79,000h (L80B50)

Inrush current

Inrush current: 5 A / 100 μs
 Maximum number of luminaires of this type per miniature circuit breaker:
 B 10A: 56 luminaires
 B 16A: 90 luminaires
 C 10A: 56 luminaires
 C 16A: 90 luminaires

Lighting technology

Half beam angle 47°
 Luminaire data for the light planning program DIALux for outdoor lighting, street lighting and interior lighting as well as luminaire data in EULUMDAT and IES format are available on our website www.bega.com.

Article No. 77 665

LED colour temperature optionally 4000K or 3000K
 4000 K – Article number + **K4**
 3000 K – Article number + **K3**

Colour graphite or silver
 graphite – article number
 silver – article number + **A**

Accessories

70 060 Exchangeable lens flat beam
70 757 Shield

For the accessories a separate instructions for use can be provided upon request.

Light distribution

