

BEGA**50 264.3**

Wall luminaire for indoor use



Project · Reference number

Date

Product data sheet

Application

Shielded LED wall luminaire · indoor luminaire
made of hand-blown opal glass, satin matt with
metal shield, for many lighting tasks.
The light emits upwards and downwards.

Product description

Metal housing, finish
white enamel
Hand-blown opal glass, satin matt
Metal shield, polished stainless steel finish
2 elongated fixing holes
Width 4.5 mm · 185 mm spacing
1 cable entry for through-wiring
for mains cable
Connecting terminals 2.5[□]
Earth conductor connection
LED-Module for mains voltage
220-230 V ~ 50/60 Hz
Safety class I
 – Safety mark
 – Conformity mark
Weight: 1.2 kg

Light technique

Luminaire data for the light planning program
DIALux for outdoor lighting, street lighting and
indoor lighting as well as luminaire data in
EULUMDAT- and IES-format you will find on the
BEGA web page www.bega.com.

Lamp

Luminaire connected wattage	12 W
Rated temperature	$t_a = 25 \text{ °C}$
Ambient temperature	$t_{a \text{ max}} = 50 \text{ °C}$
Service life criteria	50 000 h / L ₇₀

50 264.3 K3

Module designation	LED-0607/830
Colour temperature	3000 K
Colour rendering index	$R_a > 80$
Module luminous flux	1080 lm
Luminaire luminous flux	512 lm
Luminaire luminous efficiency	42,7 lm/W

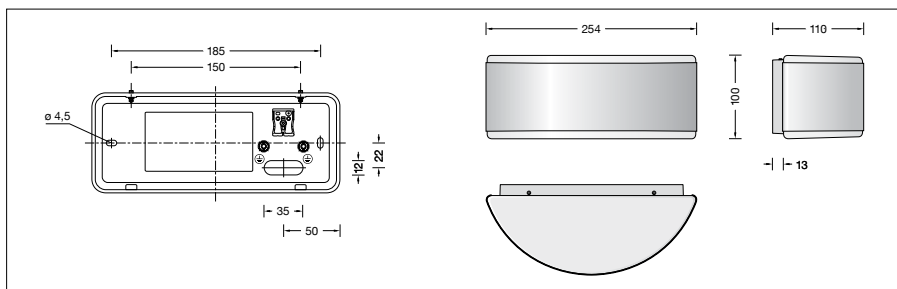

Article No. 50 264.3

Finish options

- | | |
|----------------------------|-----------------------|
| • Enamel, white | Code number .1 |
| • Stainless steel | Code number .2 |
| • Polished stainless steel | Code number .3 |