

**BEGA****50 264.2**

Wall luminaire for indoor use



Project · Reference number

Date

## Product data sheet

### Application

Shielded LED wall luminaire · indoor luminaire  
made of hand-blown opal glass, satin matt with  
metal shield, for many lighting tasks.  
The light emits upwards and downwards.

### Product description

Metal housing, finish  
white enamel  
Hand-blown opal glass, satin matt  
Metal shield, stainless steel finish  
2 elongated fixing holes  
Width 4.5 mm · 185 mm spacing  
1 cable entry for through-wiring  
for mains cable  
Connecting terminals 2.5<sup>□</sup>  
Earth conductor connection  
LED-Module for mains voltage  
220-230 V ~ 50/60 Hz  
Safety class I  
 – Safety mark  
 – Conformity mark  
Weight: 1.2 kg

### Light technique

Luminaire data for the light planning program  
DIALux for outdoor lighting, street lighting and  
indoor lighting as well as luminaire data in  
EULUMDAT- and IES-format you will find on the  
BEGA web page [www.bega.com](http://www.bega.com).

### Lamp

Luminaire connected wattage	12 W
Rated temperature	$t_a = 25\text{ °C}$
Ambient temperature	$t_{a\text{max}} = 50\text{ °C}$
Service life criteria	50 000 h / L <sub>70</sub>

### 50 264.2 K3

Module designation	LED-0607/830
Colour temperature	3000 K
Colour rendering index	$R_a > 80$
Module luminous flux	1080 lm
Luminaire luminous flux	512 lm
Luminaire luminous efficiency	42,7 lm/W

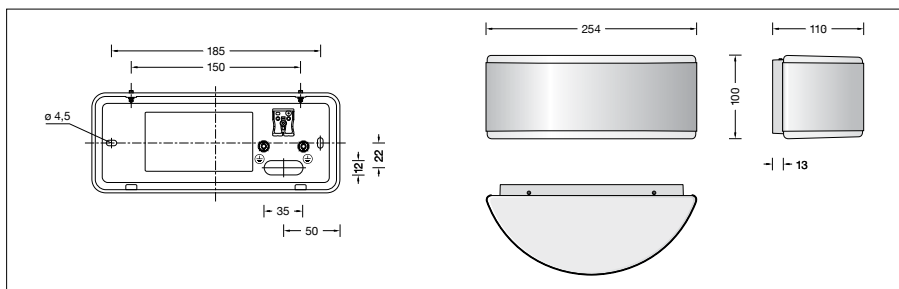

### Article No. 50 264.2

Finish options

- |                            |                       |
|----------------------------|-----------------------|
| • Enamel, white            | Code number <b>.1</b> |
| • Stainless steel          | Code number <b>.2</b> |
| • Polished stainless steel | Code number <b>.3</b> |