

BEGA**50 264.1**

Wall luminaire for indoor use



Project · Reference number



Date

Product data sheet

Application

Shielded LED wall luminaire · indoor luminaire
made of hand-blown opal glass, satin matt with
metal shield, for many lighting tasks.
The light emits upwards and downwards.

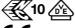
Product description

Metal housing, finish
white enamel
Hand-blown opal glass, satin matt
Metal shield,
enamel white finish
2 elongated fixing holes
Width 4.5 mm · 185 mm spacing
1 cable entry for through-wiring
for mains cable
Connecting terminals 2.5[□]
Earth conductor connection
LED-Module for mains voltage
220-230 V ~ 50/60 Hz
Safety class I
 – Safety mark
 – Conformity mark
Weight: 1.2 kg

Light technique

Luminaire data for the light planning program
DIALux for outdoor lighting, street lighting and
indoor lighting as well as luminaire data in
EULUMDAT- and IES-format you will find on the
BEGA web page www.bega.com.

Lamp

Luminaire connected wattage 12 W
Rated temperature $t_a = 25\text{ °C}$
Ambient temperature $t_{a\text{ max}} = 50\text{ °C}$
Service life criteria 50 000 h/L₇₀

50 264.1 K3

Module designation LED-0607/830
Colour temperature 3000 K
Colour rendering index $R_a > 80$
Module luminous flux 1080 lm
Luminaire luminous flux 512 lm
Luminaire luminous efficiency 42,7 lm/W

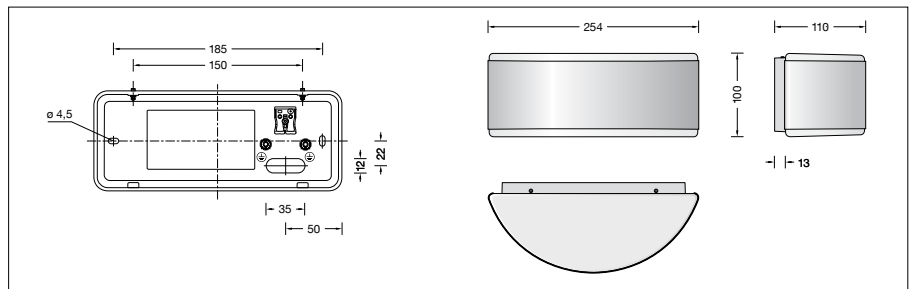

Article No. 50 264.1

Finish options

- Enamel, white Code number **.1**
- Stainless steel Code number **.2**
- Polished stainless steel Code number **.3**