

**BEGA****50 262**

Wall luminaire for indoor use



Project · Reference number



Date

## Product data sheet

### Application

Free-radiating LED wall luminaire · indoor  
luminaire made of hand-blown opal glass, satin  
matt and metal housing, for all lighting tasks.

### Product description

Metal housing, finish  
white enamel  
Hand-blown opal glass, satin matt  
2 elongated fixing holes  
Width 4,5 mm · 185 mm spacing  
1 cable entry for through-wiring  
for mains cable  
Connecting terminals 2.5<sup>□</sup>  
Earth conductor connection  
LED-Module for mains voltage  
220-230 V ~ 50/60 Hz  
Safety class I  
 – Safety mark  
 – Conformity mark  
Weight: 0.95 kg

### Lamp

Luminaire connected wattage	12 W
Rated temperature	$t_a = 25 \text{ °C}$
Ambient temperature	$t_{a \text{ max}} = 50 \text{ °C}$
Service life criteria	50 000 h / L <sub>70</sub>

### 50 262 K3

Module designation	LED-0607/830
Colour temperature	3000 K
Colour rendering index	$R_a > 80$
Module luminous flux	1080 lm
Luminaire luminous flux	905 lm
Luminaire luminous efficiency	75,4 lm/W

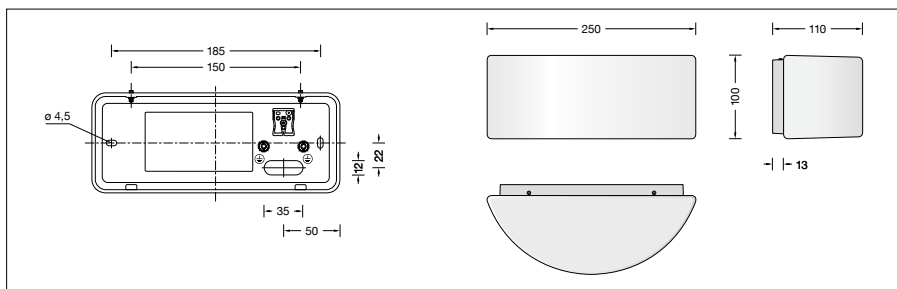

### Light technique

Luminaire data for the light planning program  
DIALux for outdoor lighting, street lighting and  
indoor lighting as well as luminaire data in  
EULUMDAT- and IES-format you will find on the  
BEGA web page [www.bega.com](http://www.bega.com).