

**BEGA****33 170**

Recessed luminaire



Project · Reference number

Date

## Product data sheet

### Application

Recessed LED location luminaire for installation in walls or stairs.  
Installation possible in horizontal or vertical burning position.

### Product description

Luminaire made of stainless steel  
Steel grade no. 1.4301  
Safety glass, white  
Silicone gasket  
Required recessed opening 155 x 60 mm  
Recessed depth 90 mm  
Fixing is achieved by using two adjustable wedge-shaped claws  
Connecting cable H05RN-F 3 x 1<sup>□</sup>  
Cable length 0,2 m  
Enclosed line connector for through-wiring of mains supply cable ø 6,5 - 12 mm max. 3 x 4<sup>□</sup>  
LED power supply unit  
220-240 V ~ 0/50-60 Hz  
DC 176-264 V  
Safety class I  
Protection class IP 65  
Dust-tight and protection against water jets  
Impact strength IK06  
Protection against mechanical impacts < 1 joule  
 – Safety mark  
 – Conformity mark  
Weight: 0.55 kg

### Inrush current

Inrush current: 6 A / 102 μs  
Maximum number of luminaires of this type per miniature circuit breaker:  
B 10A: 60 luminaires  
B 16A: 96 luminaires  
C 10A: 100 luminaires  
C 16A: 161 luminaires

### Lamp

Module connected wattage	1.9 W
Luminaire connected wattage	2.5 W
Rated temperature	$t_a = 25\text{ °C}$
Ambient temperature	$t_{a\text{ max}} = 55\text{ °C}$
When installed in heat-insulating material	$t_{a\text{ max}} = 50\text{ °C}$

### 33 170 K3

Module designation	LED-0645/830
Colour temperature	3000 K
Colour rendering index	CRI > 80
Module luminous flux	375 lm
Luminaire luminous flux	104 lm
Luminaire luminous efficiency	41,6 lm/W

### 33 170 K4

Module designation	LED-0645/840
Colour temperature	4000 K
Colour rendering index	CRI > 80
Module luminous flux	390 lm
Luminaire luminous flux	109 lm
Luminaire luminous efficiency	43,6 lm/W

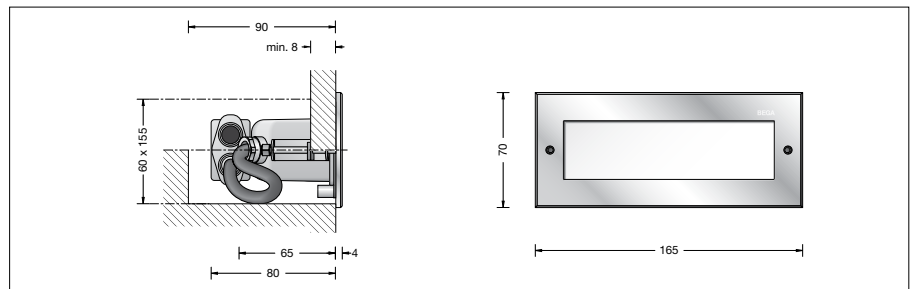
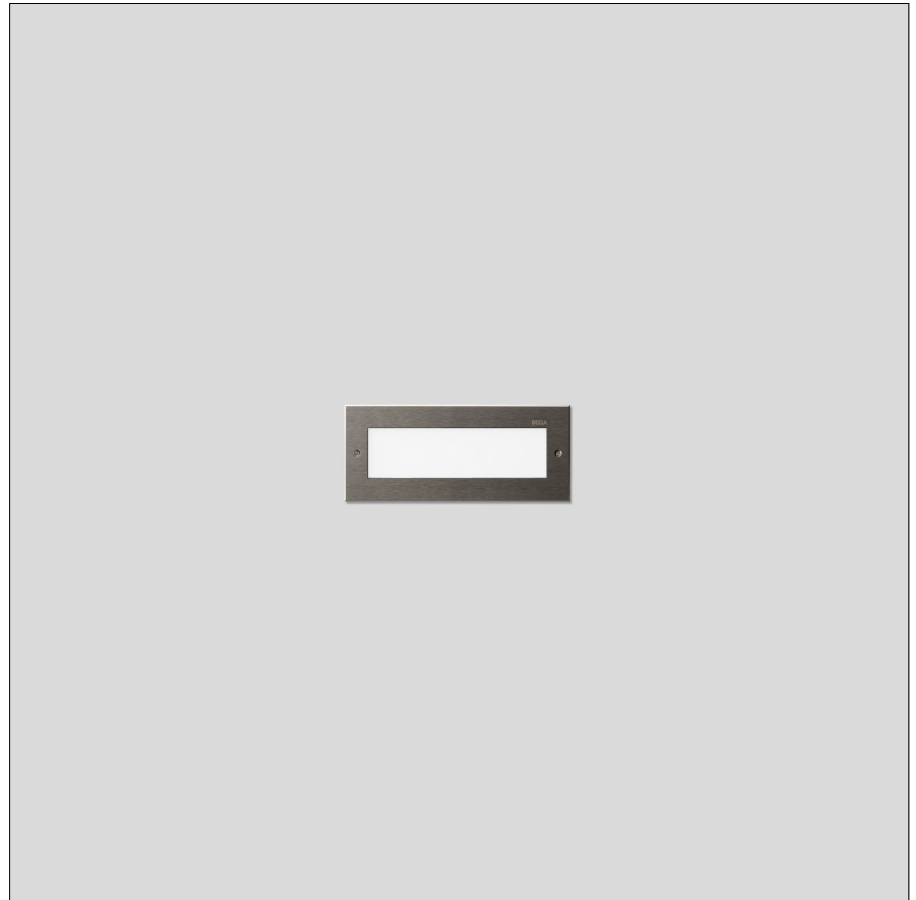

### Service life · Ambient temperature

Ambient temperature $t_a = 25\text{ °C}$	
LED psu:	> 50,000 h
LED module:	> 200,000 h (L 80 B 50) 100,000 h (L 90 B 50)

### Article No. 33 170

LED colour temperature optionally 3000 K or 4000 K  
3000 K – Article number + **K3**  
4000 K – Article number + **K4**

Ambient temperature $t_a = 55\text{ °C}$	
LED psu:	50,000 h
LED module:	67,000 h (L 80 B 50) 100,000 h (L 70 B 50)

### Accessories

**10 424** Installation housing

A separate instructions for use can be provided upon request.

### Light technique

Luminaire data for the light planning program DIALux for outdoor lighting, street lighting and indoor lighting as well as luminaire data in EULUMDAT- and IES-format you will find on the BEGA web page [www.bega.com](http://www.bega.com).

### Light distribution

