

**BEGA****33 166**

Recessed luminaire



Project · Reference number

Date

## Product data sheet

### Application

Recessed LED location luminaire for installation in walls or stairs.

### Product description

Luminaire made of aluminium alloy,  
aluminium and stainless steel  
Safety glass, white  
Silicone gasket  
Fixing is achieved by using two adjustable  
wedge-shaped claws  
Required recessed opening 306 x 60 mm  
Recessed depth 70 mm  
2 cable entries for through-wiring of mains  
supply cable  $\varnothing$  7-10,5 mm,  
max. 3G 1.5<sup>□</sup>  
Connecting terminal 2.5<sup>□</sup>  
Earth conductor connection  
LED power supply unit  
220-240 V  $\sim$  0/50-60 Hz  
DC 176-264 V  
Safety class I  
Protection class IP 65  
Dust-tight and protection against water jets  
Impact strength IK07  
Protection against mechanical  
impacts < 2 joule  
 – Safety mark  
**CE** – Conformity mark  
Weight: 0.95 kg

### Inrush current

Inrush current: 7 A / 112  $\mu$ s  
Maximum number of luminaires of this  
type per miniature circuit breaker:  
B 10 A: 38 luminaires  
B 16 A: 61 luminaires  
C 10 A: 64 luminaires  
C 16 A: 102 luminaires

### Lamp

Module connected wattage	3.8 W
Luminaire connected wattage	4.9 W
Rated temperature	$t_a = 25^\circ\text{C}$
Ambient temperature	$t_{a\text{max}} = 45^\circ\text{C}$
When installed in heat-insulating material	$t_{a\text{max}} = 40^\circ\text{C}$

On request we can offer you modifications for  
environments with higher temperatures as a  
customized product.

### 33 166 K3

Module designation	LED-0644/830
Colour temperature	3000 K
Colour rendering index	CRI > 80
Module luminous flux	670 lm
Luminaire luminous flux	336 lm
Luminaire luminous efficiency	68,6 lm/W

### 33 166 K4

Module designation	LED-0644/840
Colour temperature	4000 K
Colour rendering index	CRI > 80
Module luminous flux	705 lm
Luminaire luminous flux	353 lm
Luminaire luminous efficiency	72 lm/W

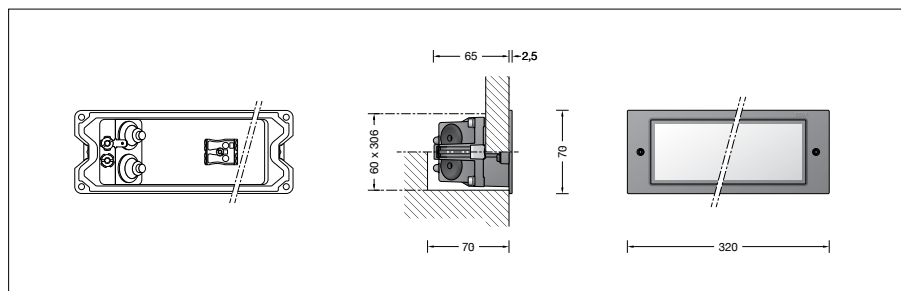
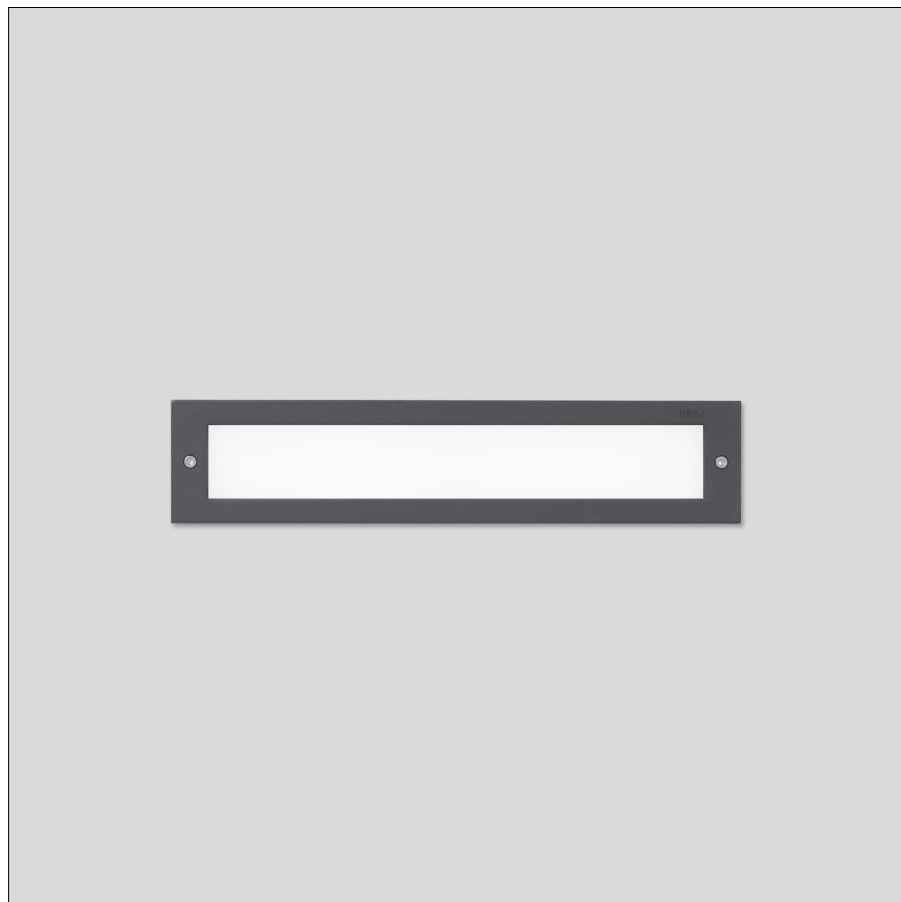

### Lifetime of the LED

Ambient temperature  $t_a = 15^\circ\text{C}$   
– at 50,000 h: L 90 B 10  
– at 220,000 h: L 70 B 50

Ambient temperature  $t_a = 25^\circ\text{C}$   
– at 50,000 h: L 90 B 50  
– at 195,000 h: L 70 B 50

max. ambient temperature  $t_a = 45^\circ\text{C}$   
– at 50,000 h: L 90 B 50  
– at 180,000 h: L 70 B 50

### Article No. 33 166

LED colour temperature optionally 3000 K  
or 4000 K  
3000 K – Article number + **K3**  
4000 K – Article number + **K4**

Colour graphite or silver  
graphite – article number  
silver – article number + **A**

### Accessories

**10 426** Installation housing  
**13 521** Installation housing for installation in  
insulated facades (EWIS)

**10 026** Plaster frame  
**13 505** Plaster frame flush

A separate instructions for use can be provided  
upon request.

### Light distribution

