

**BEGA****31 101**

Recessed wall luminaire



Project · Reference number

Date

## Product data sheet

### Application

LED wall luminaire made of massive bronze alloy and stainless steel.  
Luminaire for versatile applications where a highly robust construction and corrosion resistance are required.  
The fixing system of the luminaire allows an easy installation in enclosed or hollow constructions without additional fixing holes.  
For the installation in walls made of concrete or brick work a suitable installation housing is available.

### Product description

Luminaire cover made of cast bronze  
Luminaire housing made of stainless steel  
Steel grade number 1.4301  
Crystal glass with optical texture, white inside  
Silicone gasket  
Fixing is achieved by using three adjustable wedge-shaped claws  
2 cable entries for through-wiring of mains supply cable  $\varnothing$  7-10,5 mm, max. 3G1.5<sup>□</sup>  
Connection terminal 2.5<sup>□</sup>  
Earth conductor connection  
LED power supply unit  
220-240 V  $\sim$  0/50-60 Hz  
DC 170-240 V  
Safety class I  
Protection class IP 65  
Dust-tight and protection against water jets  
 – Safety mark  
**CE** – Conformity mark  
Weight: 5.0 kg

### Bronze

The luminaire is made of massive bronze and delivered with the metal's natural surface.  
Time and weather factors create the natural patina characteristic for bronze.

### Lamp

Module connected wattage	7.9 W
Luminaire connected wattage	9 W
Rated temperature	$t_a = 25 \text{ }^\circ\text{C}$
Ambient temperature	$t_{a, \text{max}} = 50 \text{ }^\circ\text{C}$

### 31 101 K3

Module designation	LED-0276/830
Colour temperature	3000 K
Colour rendering index	CRI > 80
Module luminous flux	1425 lm
Luminaire luminous flux*	178 lm
Luminaire luminous efficiency*	19,8 lm/W

\* preliminary data

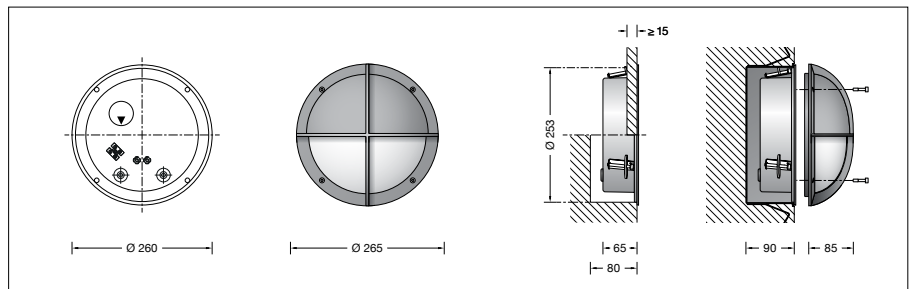

### Service life of the LED

Ambient temperature  $t_a = 25 \text{ }^\circ\text{C}$   
– at > 500,000 h: L70B50  
max. ambient temperature  $t_a = 50 \text{ }^\circ\text{C}$   
– at 130,000 h: L70B50

### Accessories

**10 002** Installation housing

A separate instructions for use can be provided upon request.