

BEGA**31 100**

Recessed wall luminaire



Project · Reference number

Date

Product data sheet

Application

LED wall luminaire made of massive bronze alloy and stainless steel.
Luminaire for versatile applications where a highly robust construction and corrosion resistance are required.
The fixing system of the luminaire allows an easy installation in enclosed or hollow constructions without additional fixing holes.
For the installation in walls made of concrete or brick work a suitable installation housing is available.

Product description

Luminaire cover made of cast bronze
Luminaire housing made of stainless steel
Steel grade number 1.4301
Crystal glass with optical texture, white inside
Silicone gasket
Fixing is achieved by using three adjustable wedge-shaped claws
2 cable entries for through-wiring of mains supply cable \varnothing 7-10,5 mm, max. 3G1.5[□]
Connection terminal 2.5[□]
Earth conductor connection
LED power supply unit
220-240 V \sim 0/50-60 Hz
DC 176-264 V
Safety class I
Protection class IP 65
Dust-tight and protection against water jets
Impact strength IK06
Protection against mechanical impacts < 1 joule
 – Safety mark
 – Conformity mark
Weight: 2.7 kg

Bronze

The luminaire is made of massive bronze and delivered with the metal's natural surface.
Time and weather factors create the natural patina characteristic for bronze.

Inrush current

Inrush current: 7 A / 112 μ s
Maximum number of luminaires of this type per miniature circuit breaker:
B10A: 38 luminaires
B16A: 61 luminaires
C10A: 64 luminaires
C16A: 102 luminaires

Light technique

Luminaire data for the light planning program DIALux for outdoor lighting, street lighting and indoor lighting as well as luminaire data in EULUMDAT- and IES-format you will find on the BEGA web page www.bega.com.

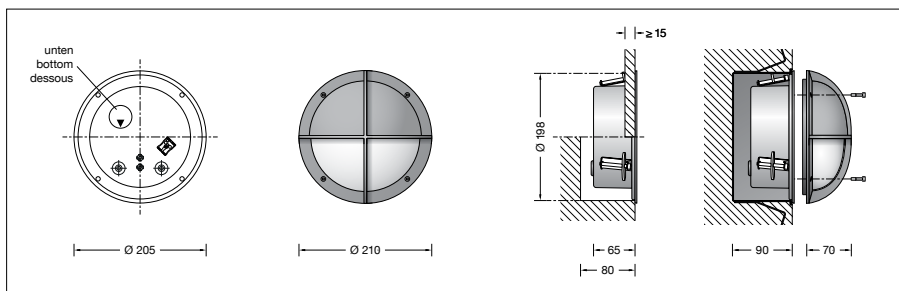

Lamp

Module connected wattage	3.9 W
Luminaire connected wattage	5 W
Rated temperature	$t_a = 25$ °C
Ambient temperature	$t_{a \max} = 45$ °C
When installed in heat-insulating material	$t_{a \max} = 40$ °C

On request we can offer you modifications for environments with higher temperatures as a customized product.

31 100 K3

Module designation	LED-0480/830
Colour temperature	3000 K
Colour rendering index	CRI > 80
Module luminous flux	715 lm
Luminaire luminous flux	147 lm
Luminaire luminous efficiency	29,4 lm/W

Lifetime of the LED

Ambient temperature $t_a = 25$ °C
– at > 500,000h: L70B50
max. ambient temperature $t_a = 45$ °C
– at 254,000h: L70B50

Accessories

10001 Installation housing

A separate instructions for use can be provided upon request.