

BEGA**24 083**

Recessed wall luminaire



Project · Reference number

Date

Product data sheet

Application

Recessed wall luminaires made of cast bronze.
Shielded LED luminaire for glare-free illumination of surfaces from low mounting height.
The used LED technique offers durability and optimal light output with low power consumption at the same time.

Product description

Luminaire cover made of cast bronze
Luminaire housing made of stainless steel
Steel grade number 1.4301
Safety glass with optical structure
Silicone gasket
Recessed opening \varnothing 130 mm
Recessed depth required 100 mm
Fixing is achieved by using two adjustable wedge-shaped claws
1 cable entry for mains supply cable up to \varnothing 10,5 mm max. $3 \times 1,5^{\square}$
Connection terminal 2.5^{\square}
Earth conductor connection
LED power supply unit
220-240 V \sim 0/50-60 Hz
DC 176-264 V
Safety class I
Protection class IP 65
Dust-tight and protection against water jets
Impact strength IK05
Protection against mechanical impacts < 0.7 joule
 – Safety mark
CE – Conformity mark
Weight: 1.8 kg

Lamp

Module connected wattage	4 W
Luminaire connected wattage	6 W
Rated temperature	$t_a = 25^{\circ}\text{C}$
Ambient temperature	$t_{a\text{max}} = 30^{\circ}\text{C}$

On request we can offer you modifications for environments with higher temperatures as a customized product.

24 083 K3

Module designation	LED-0142/830
Colour temperature	3000 K
Colour rendering index	CRI > 80
Module luminous flux	515 lm
Luminaire luminous flux	198 lm
Luminaire luminous efficiency	33 lm/W

24 083 K4

Module designation	LED-0142/840
Colour temperature	4000 K
Colour rendering index	CRI > 80
Module luminous flux	550 lm
Luminaire luminous flux	211 lm
Luminaire luminous efficiency	35,2 lm/W

Light distribution

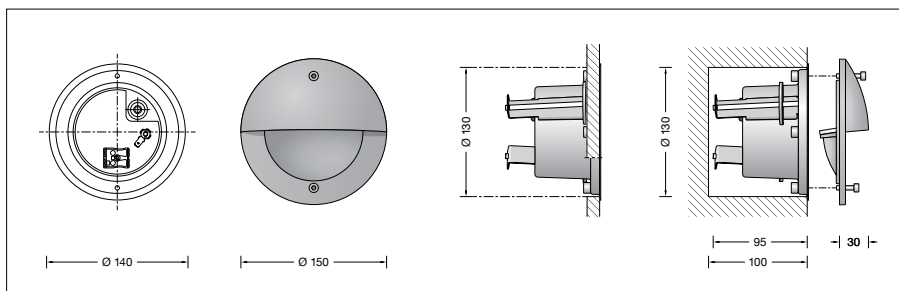
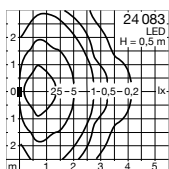

Service life · Ambient temperature

Ambient temperature $t_a = 25^{\circ}\text{C}$	
LED psu:	> 50,000 h
LED module:	94,000 h (L 80 B 50) 100,000 h (L 70 B 50)

Ambient temperature $t_a = 30^{\circ}\text{C}$	
LED psu:	50,000 h
LED module:	88,000 h (L 80 B 50) 100,000 h (L 70 B 50)

Light technique

Luminaire data for the light planning program DIALux for outdoor lighting, street lighting and indoor lighting as well as luminaire data in EULUMDAT- and IES-format you will find on the BEGA web page www.bega.com.

Inrush current

Inrush current: 20 A / 170 μs
Maximum number of luminaires of this type per miniature circuit breaker:
B 10A: 31 luminaires
B 16A: 50 luminaires
C 10A: 52 luminaires
C 16A: 85 luminaires

Article No. 24 083

LED colour temperature optionally 3000K or 4000K

3000 K – Article number + **K3**
4000 K – Article number + **K4**

Accessories

10 428 Installation housing

A separate instructions for use can be provided upon request.