

BEGA**24 064**

Recessed wall luminaire



Project · Reference number

Date

Product data sheet

Application

LED surface washer for illuminating ground surfaces from an extremely low mounting height. Recessed wall luminaire for glare-free spatial illumination with good uniformity.

Product description

Luminaire made of aluminium alloy, aluminium and stainless steel
 Safety glass with optical structure
 Silicone gasket
 Reflector made of pure anodised aluminium
 Fixing is achieved by using two adjustable wedge-shaped claws
 Required recessed opening 245 x 60 mm
 Recessed depth 70 mm
 2 cable entries for through-wiring of mains supply cable \varnothing 7-10.5 mm
 Connection terminal 2.5²
 Earth conductor connection
 LED power supply unit
 220-240 V \approx 0/50-60 Hz
 DC 198-264 V
 Safety class I
 Protection class IP 65
 Dust-tight and protection against water jets
 Impact strength IK06
 Protection against mechanical impacts < 1 joule
 – Safety mark
 – Conformity mark
 Weight: 0.75 kg

Inrush current

Inrush current: 27 A / 250 μ s
 Maximum number of luminaires of this type per miniature circuit breaker:
 B 10A: 17 luminaires
 B 16A: 27 luminaires
 C 10A: 28 luminaires
 C 16A: 45 luminaires

Lamp

Module connected wattage	7.2 W
Luminaire connected wattage	9.2 W
Rated temperature	$t_a = 25\text{ }^\circ\text{C}$
Ambient temperature	$t_{a\text{ max}} = 40\text{ }^\circ\text{C}$
When installed in heat-insulating material	$t_{a\text{ max}} = 30\text{ }^\circ\text{C}$

On request we can offer you modifications for environments with higher temperatures as a customized product.

24 064 K3

Module designation	LED-0740/830
Colour temperature	3000 K
Colour rendering index	CRI > 80
Module luminous flux	1125 lm
Luminaire luminous flux	489 lm
Luminaire luminous efficiency	53,2 lm/W

24 064 K4

Module designation	LED-0740/840
Colour temperature	4000 K
Colour rendering index	CRI > 80
Module luminous flux	1135 lm
Luminaire luminous flux	493 lm
Luminaire luminous efficiency	53,6 lm/W

Light distribution

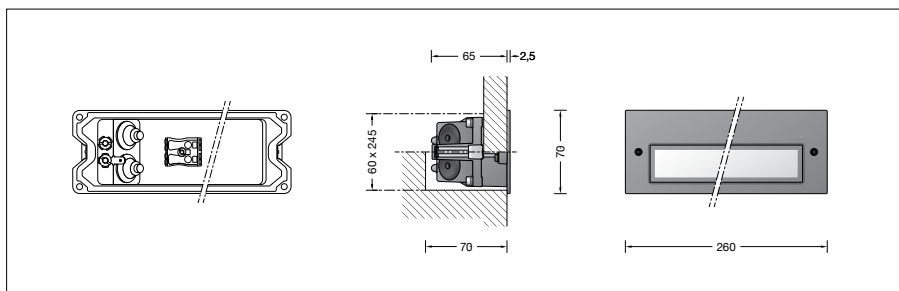
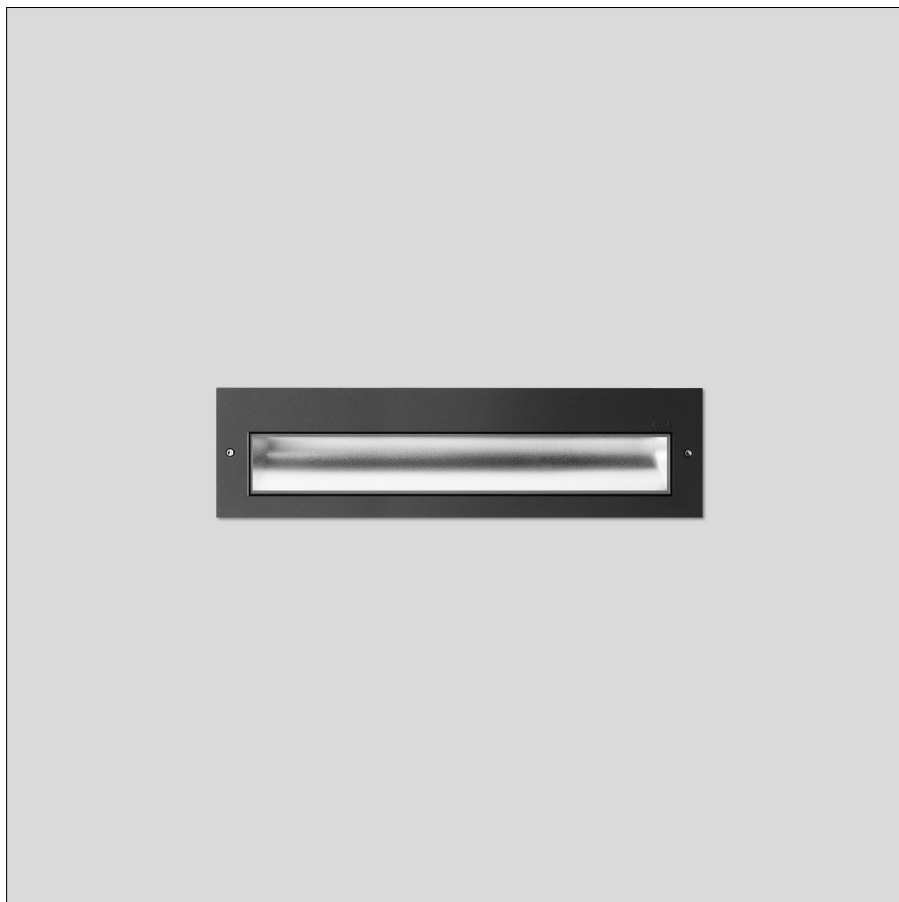
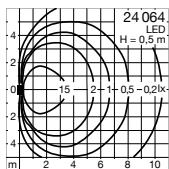

Service life · Ambient temperature

Ambient temperature $t_a = 25\text{ }^\circ\text{C}$
 LED psu: > 50,000 h
 LED module: > 200,000 h (L 80 B 50)
 100,000 h (L 90 B 50)

Ambient temperature $t_a = 40\text{ }^\circ\text{C}$
 LED psu: 50,000 h
 LED module: > 200,000 h (L 80 B 50)
 100,000 h (L 90 B 50)

Light technique

Luminaire data for the light planning program DIALux for outdoor lighting, street lighting and indoor lighting as well as luminaire data in EULUMDAT- and IES-format you will find on the BEGA web page www.bega.com.

Article No. 24 064

LED colour temperature optionally 3000 K or 4000 K
 3000 K – Article number + **K3**
 4000 K – Article number + **K4**

Colour graphite or silver
 graphite – article number
 silver – article number + **A**

Accessories

10 425 Installation housing
13 520 Installation housing for installation in insulated façades (EWIS)
10 025 Plaster frame
13 504 Plaster frame flush

A separate instructions for use can be provided upon request.