

GLASHÜTTE LIMBURG**Product data sheet****Wall luminaire****12 282.2**

Project · Reference number

Date

Application

Shielded wall luminaire for many lighting tasks in interior applications.
The light emits upwards and downwards.
The used LED technique offers durability and optimal light output with low power consumption at the same time.

Product description

Aluminium alloy housing,
stainless steel finish
Crystal glass, inside white
2 mounting holes \varnothing 4.5 mm
Elongated holes · 176 mm spacing
2 cable entries for through-wiring for mains cable up to \varnothing 10.5 mm max. $3 \times 1.5^{\square}$
Connecting terminal 2.5 $^{\square}$
Earth conductor connection
LED power supply unit
220-240 V \sim 0/50-60 Hz
Safety class I
CE – Conformity mark
Weight: 0.95 kg

Lamp

Module connected wattage	8.4 W
Luminaire connected wattage	10.7 W
Rated temperature	$t_a = 25^{\circ}\text{C}$
Ambient temperature	$t_{a\text{max}} = 35^{\circ}\text{C}$

12 282.2

Module designation	LED-0598/930
Colour temperature	3000 K
Colour rendering index	$R_a > 90$
Module luminous flux	1055 lm
Luminaire luminous flux	389 lm
Luminaire luminous efficiency	36,4 lm/W

12 282.2 K4

Module designation	LED-0598/940
Colour temperature	4000 K
Colour rendering index	$R_a > 90$
Module luminous flux	1095 lm
Luminaire luminous flux	404 lm
Luminaire luminous efficiency	37,8 lm/W

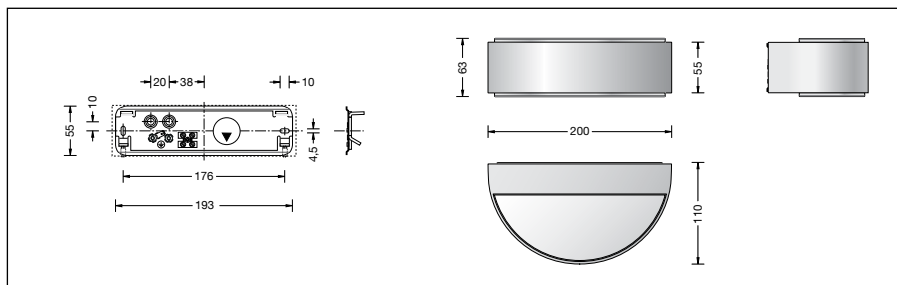
**Lifetime of the LED**

Ambient temperature $t_a = 15^{\circ}\text{C}$
 – at 50,000h: L 90 B 50
 – at 164,000h: L 70 B 50

Ambient temperature $t_a = 25^{\circ}\text{C}$
 – at 50,000h: L 80 B 50
 – at 92,000h: L 70 B 50

max. ambient temperature $t_a = 35^{\circ}\text{C}$
 – at 50,000h: L 70 B 50
 – at 54,000h: L 70 B 50

Article No. 12 282.2

Colour temperature 3000 K.
 Also available with 4000 K on request.
 3000 K – article number
 4000 K – article number + **K4**

Finish options

- Enamel, white
- Stainless steel
- Chrome

Code number **.1**
 Code number **.2**
 Code number **.3**